

*Application does not view or function correctly on a smartphone. Please use a computer or tablet.

Never logged in to Parent Portal?

Your school provided you with an Activation Key when you registered your student. Use this key to create your user account. If you don't know your key, contact your school and the secretary can locate it for you. Once you have that key:

- If using the **Campus Parent** mobile app, open the app and search for your **District Name** and **State**.
 1. Click **New User?**
 2. Enter your **Activation Key** in the space provided and then **Submit**.
 3. Enter a **Username** and **Password** and click **Submit**.

- If using a web browser, visit <https://www.nebo.edu/> and from the Parents tab, select **Infinite Campus Parent Portal**.

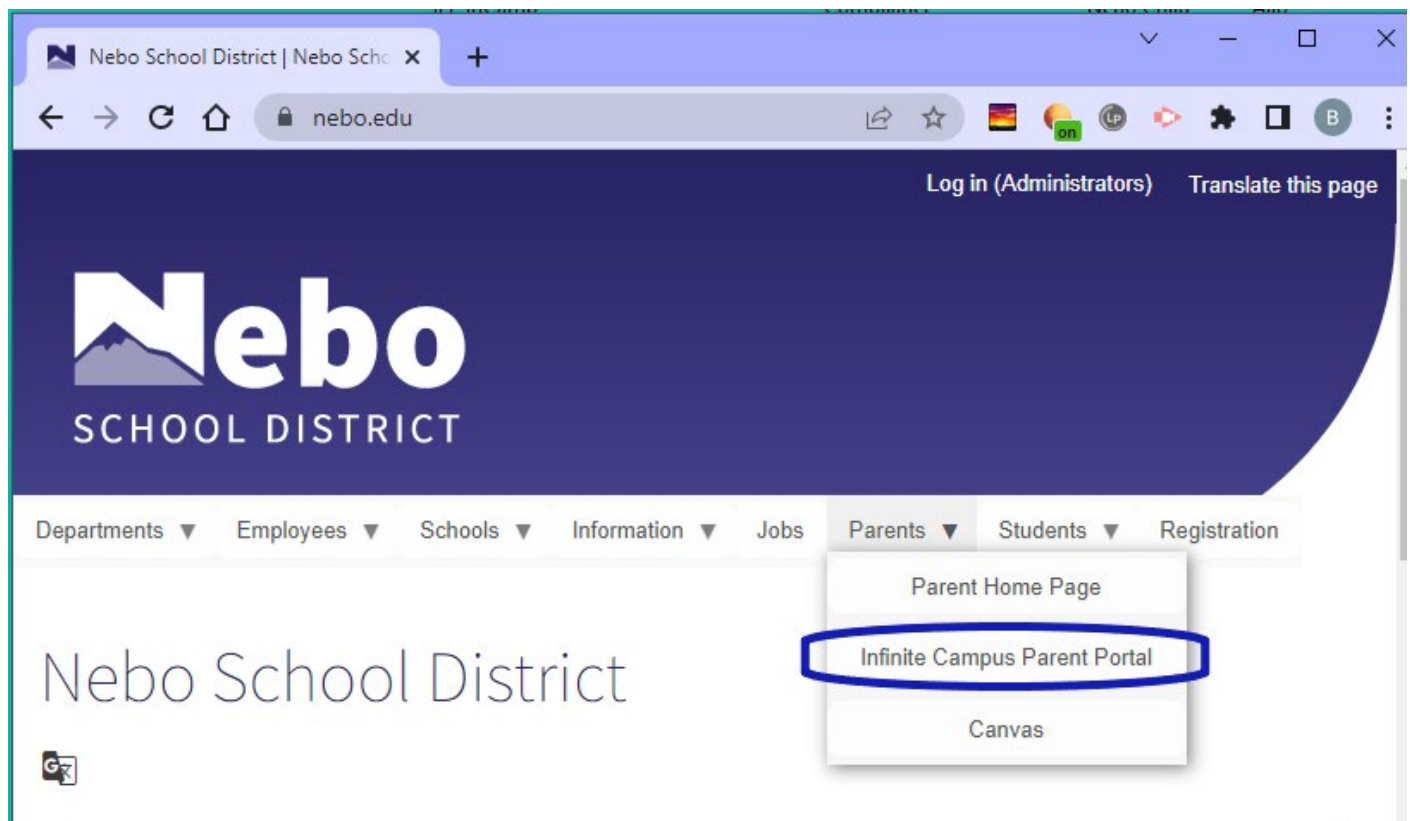

Login to your parent portal by entering your Parent Username and Password left of the screen and click **Login**

Campus provides displays in English, Spanish, and Chinese

****to change the display language of your portal **Before log in:** – scroll to the bottom and select ENGLISH or SPANISH from the dropdown box**

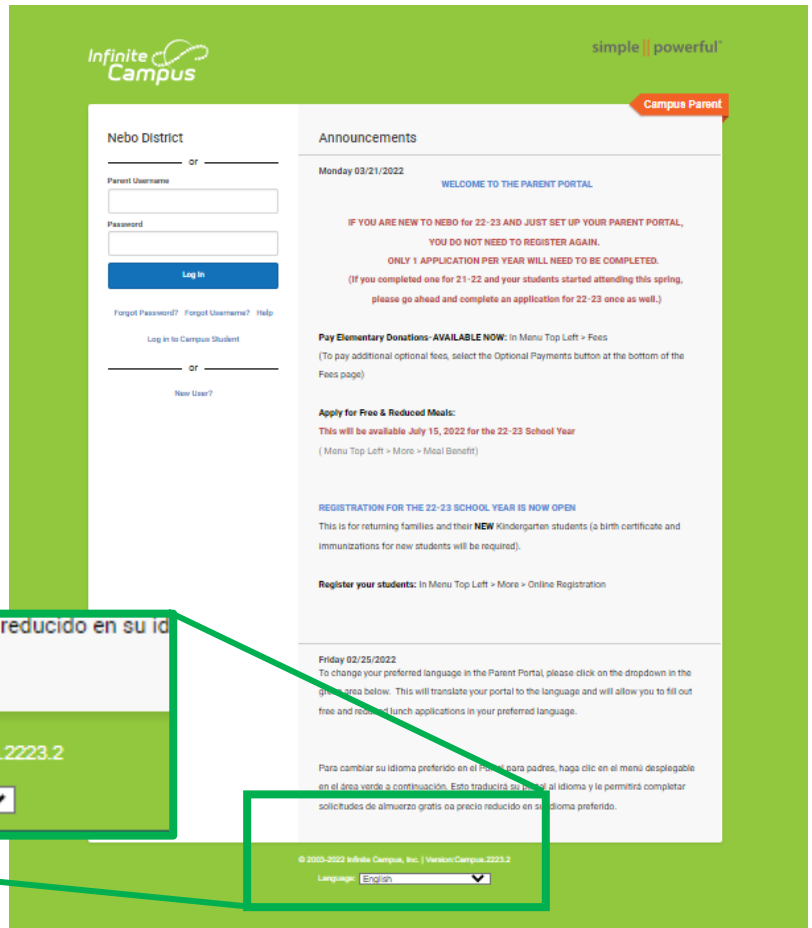

****to change the language of your portal to English or Spanish **Once logged in:** - From the user menu, click **Language** to change the language that Campus Parent displays in.**

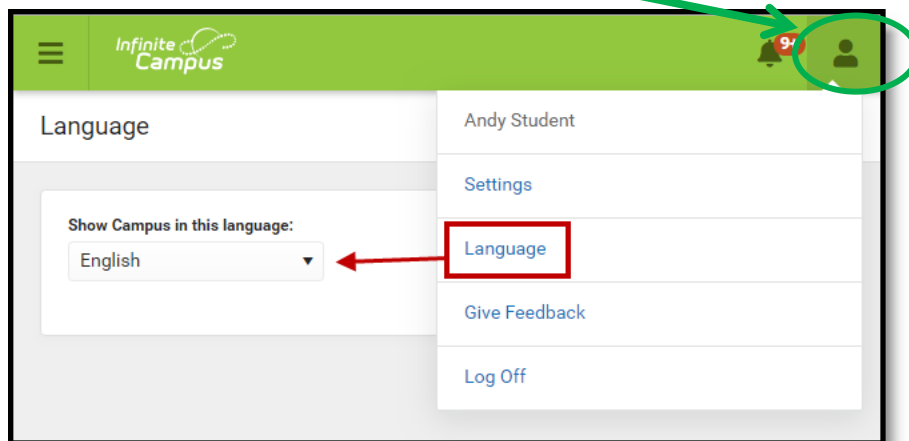

At the main screen, if you do not see the menu (black on left), select the “hamburger” or “three bars” icon.

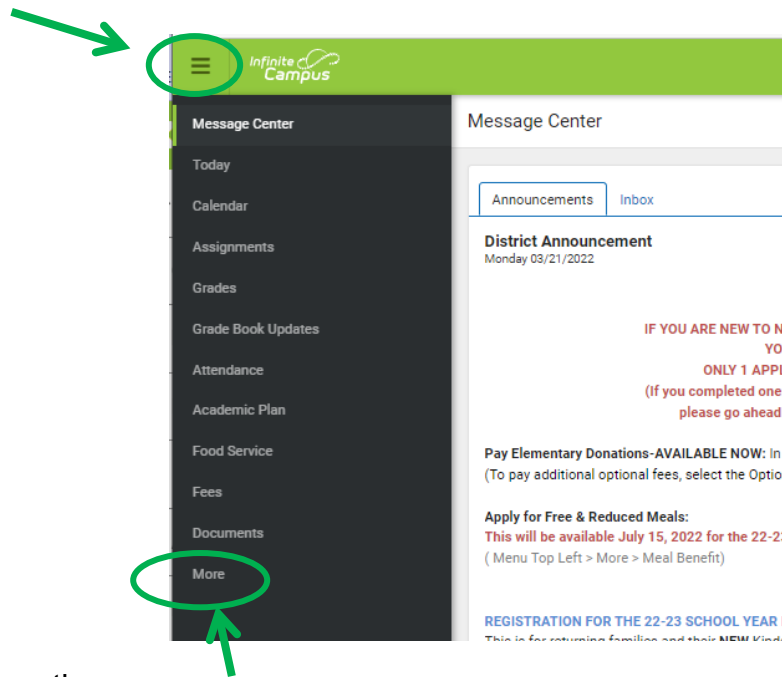

Select **More** from the menu

From the **More** menu, select **Meal Benefits**

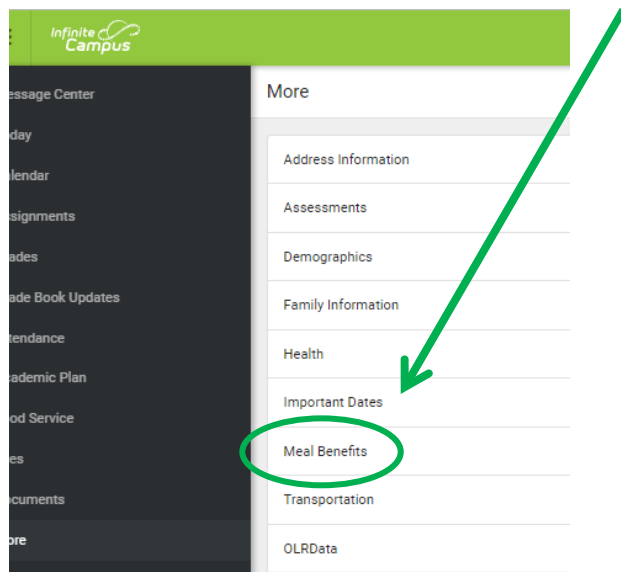

Click to start the application process

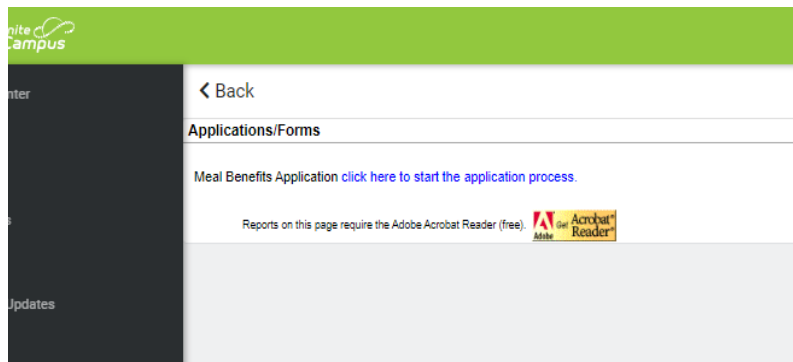

If you do not already have an E-Signature PIN setup, you will be asked to setup the pin. You will use this pin to e-sign and submit the application. Select YES to create your pin.

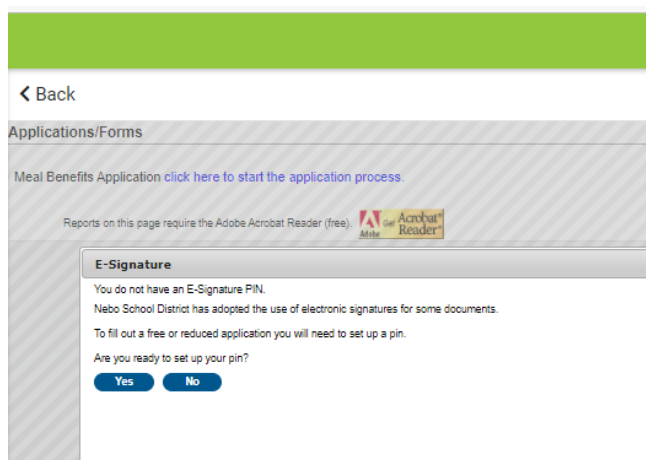

Create your PIN:

- Enter five (5) letters, numbers or special characters (!@#\$%^&*+?~|=).
- You must have at least one (1) of each of two (2) of the types.

Re-enter PIN

Password:

*this is your Parent Portal Password.

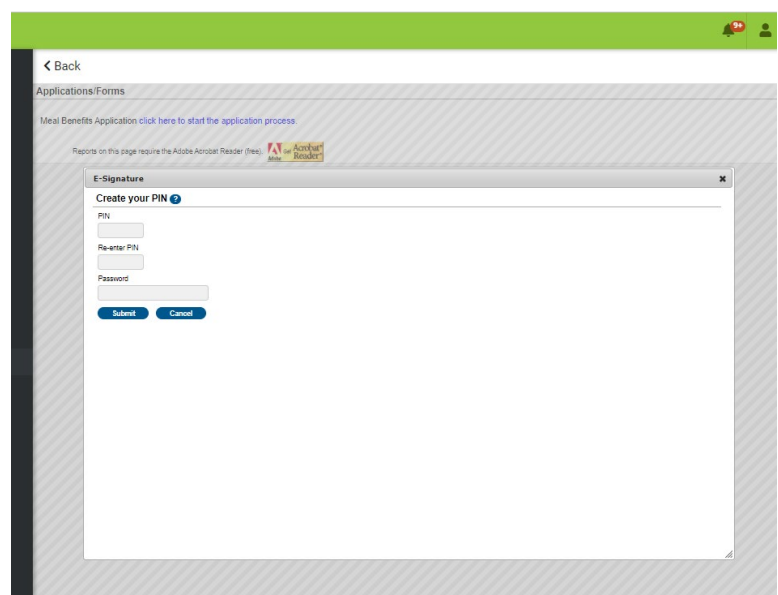

This screenshot shows the 'Letter to Household' step of the Meal Benefits Application. At the top, a navigation bar includes 'Letter to Household' (highlighted), 'Instructions', 'Signer Confirmation', 'Household Members', 'Children', 'Gross Income', 'Review', 'Authorization', and 'Submitted'. Below the navigation bar, a message states: 'Letter to Household contains important information you will need during the application process. You may print a PDF of this letter by selecting the print icon. Select 'Next' to continue or 'Quit' to stop.' A PDF viewer is embedded, displaying the title 'Letter to Household' and the text: 'Dear Parent/Guardian: Children need healthy meals to learn. Nebo School District offers healthy meals every school day. Breakfast and lunch meals are FREE for the 2021/22 school year. This packet includes an application for free or reduced price meal benefits, and a set of detailed instructions. Below are some common questions and answers to help you with the application process. 1. WHO CAN GET FREE OR REDUCED PRICE MEALS?'. At the bottom, there are 'Quit' and 'Next' buttons, and a 'Timeout 59:49' indicator.

This screenshot shows the 'Application Instructions' step of the Meal Benefits Application. The navigation bar is the same as in the previous screenshot, but 'Application Instructions' is now highlighted. The message reads: 'Application Instructions will help guide you through the application process. You may print a PDF of this letter by selecting the print icon. Select 'Next' to continue.' The PDF viewer displays the title 'How To Apply For Free And Reduced Priced Student Meals' and provides detailed instructions for the application process, including a section for 'Signer Confirmation'. At the bottom, there are 'Previous' and 'Next' buttons, and a 'Timeout 59:56' indicator.